

U.
DESIGNATION - Mt. Baker
Natural Areas
Long Creek (~~Proposed~~)
Regulation Unit

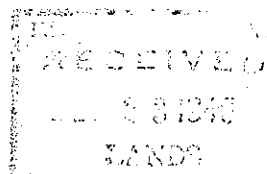

4060 LC
W14
RECEIVED
JAN 24 1946
Granite Falls, Washington
August 31, 1946

REPORT ON PROPOSAL
LONG CREEK NATURAL AREA

DESCRIPTION

The proposed area is on the Mt. Baker National Forest, Monte Cristo Ranger District, and in the South Fork Stillaguamish River watershed. It is of approximately 640 acres in extent all of which is National Forest land. The following legal subdivisions locate the area more specifically: W $\frac{1}{2}$ SEC 17, E $\frac{1}{2}$ NE $\frac{1}{4}$, E $\frac{1}{2}$ SW $\frac{1}{4}$, SE $\frac{1}{4}$, Sec 18, T 30 N., R. 9E. W. M.

All of the area is on a south facing slope extending from river flat lands to within a short distance of the top of the ridge. East and west boundaries are formed by ridges between drainages.

SPECIAL FEATURES

This unit will not interfere with the development of the surrounding area. Timber management plans can be so arranged as to not interfere with the proposed area. It is not expected that any other use will be involved in this proposal.

The tract is covered with a virgin stand of hemlock - cedar type. The trees are of all ages from seedlings to over mature trees; some cedars are enormous, mature specimens. The scattering hardwoods encountered are red alder, big leaf maple and an occasional black cottonwood.

The proposed area is infrequently visited and has little or no recreational value.

AREA BY DOMINANT COVER TYPES

Approximately 40 acres are of the non-forest type. The remainder is divided into 40 acres of Douglas-fir, old growth (6), 100 acres of Western redcedar, large (17) and 460 acres of Western hemlock, large (14).

EDUCATIONAL CONDITIONS

The elevation varies from 1500 to 3500. The entire slope is comparatively even and is broken only by small ravines. Long Creek, which crosses the area is not a large creek and does not break up the topography to any great extent. Annual precipitation amounts to over 100 inches and snow up to 6 feet in depth is not unusual in the higher portions. Temperatures will range from 20 degrees to a maximum of 95 degrees.

WILDLIFE FACTORS

Game is found on the area, chiefly deer and bear. No part of it is over populated from a game standpoint as natural forage cannot support a large population. There is no fishing within the tract.

GENERAL REMARKS

None of the area is suitable for agriculture as no arable lands were found. Immediately adjacent to the south boundary is one farm. It is occupied by one of the oldest settlers in this vicinity. His farming endeavours are almost nil and it is anticipated that eventually the farm will revert back to a forest status.

There are no roads in or adjacent to the area and it is accessible only by a little used trail.

There are no grazing values.

Investigation did not reveal any mining claim locations on the tract. There are no patented mining claims in the vicinity.

VALUE FOR NATURAL AREA VS OTHER USES

There will be no interference with the over-all Timber Management plans if this proposal is accepted. No roads will necessarily have to be constructed through the area to log other stands of timber. In spite of its non-interference with timber management planning, there is no doubt that the area would eventually be cut if it is not reserved, due to its merchantability.

It is easily accessible by roads and logging would be no problem. Approximately one and one-half miles of new road construction would serve the area.

It is not likely the area will ever be subject to recreational use.

These two use values of logging and recreation are the only ones that can contend with a natural area value in importance. Recreational values can be eliminated, leaving only that of timber use. Since the area is small and the volume of merchantable timber is limited, a reservation such as this will not seriously affect community welfare.

There should be no public sentiment against setting aside this tract. It is believed that the proposal will be favored. This ranger district has a high recreational use and the setting aside of ^{an} area to be preserved in its natural state will enhance the scenic beauty of the valley. This factor alone will result in favorable public sentiment.

This report has been prepared in response to a request of the Natural Area Committee and the acceptance of this Natural Area will give a south facing area in addition to the north facing Lake 22 Natural Area.

Respectfully submitted,

KENNETH W. WALIN,
District Ranger.

APPROVED: Sept 19 1946

H. M. Brander

H. M. BRANDER

Forest Supervisor

APPROVED: Nov 18 1946

H. J. Andrews

Regional Forester

APPROVED: Nov 25 1946

J. P. [Signature]
Director, Northwest Experiment Sta.

By virtue of the authority vested in me by Reg. U-4 of the regulations of the Secretary of Agriculture relating to the occupancy, protection and administration of National Forests, I do hereby designate as the Long Creek Natural Area, lands described in the report dated August 31, 1946 by District Ranger Kenneth W. Walin. Said lands shall here-after be administered as a Natural Area subject to the provisions of said regulations and the instructions thereunder.

Jan-2, 1947

E. S. Granger
Acting Chief, Forest Service

CLASSIFICATION

Natural Area

Long Creek (proposed)

Legend

Road

Trail

River

Creek

Natural Area

Form 974.

T. 30N P. 8E T. 30N R. 9E Mer.

Willamette Mer

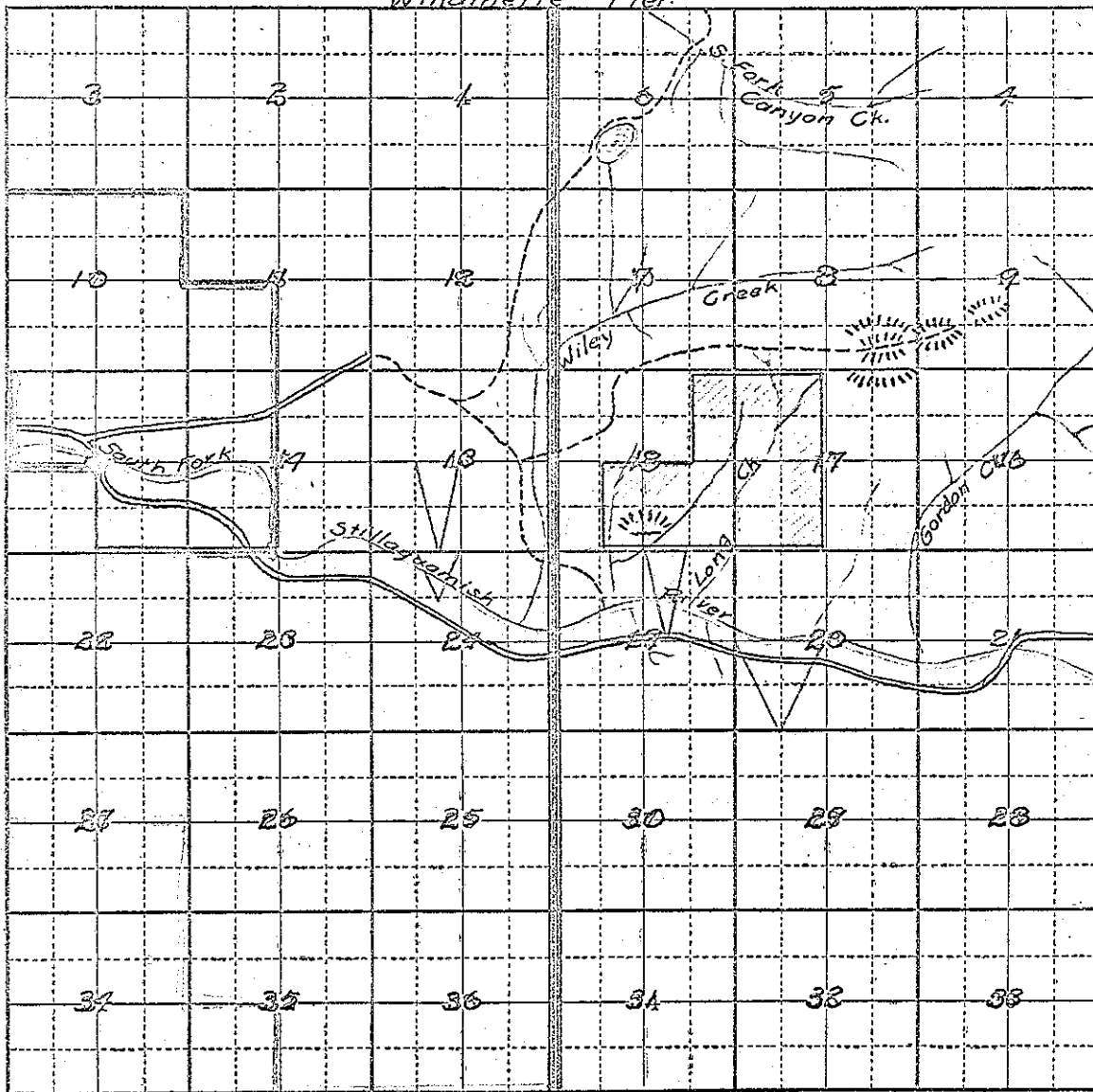

8-257

SCALE.—One inch=1 mile.

U.S. GOVERNMENT PRINTING OFFICE

8/31/46
KW

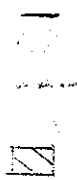
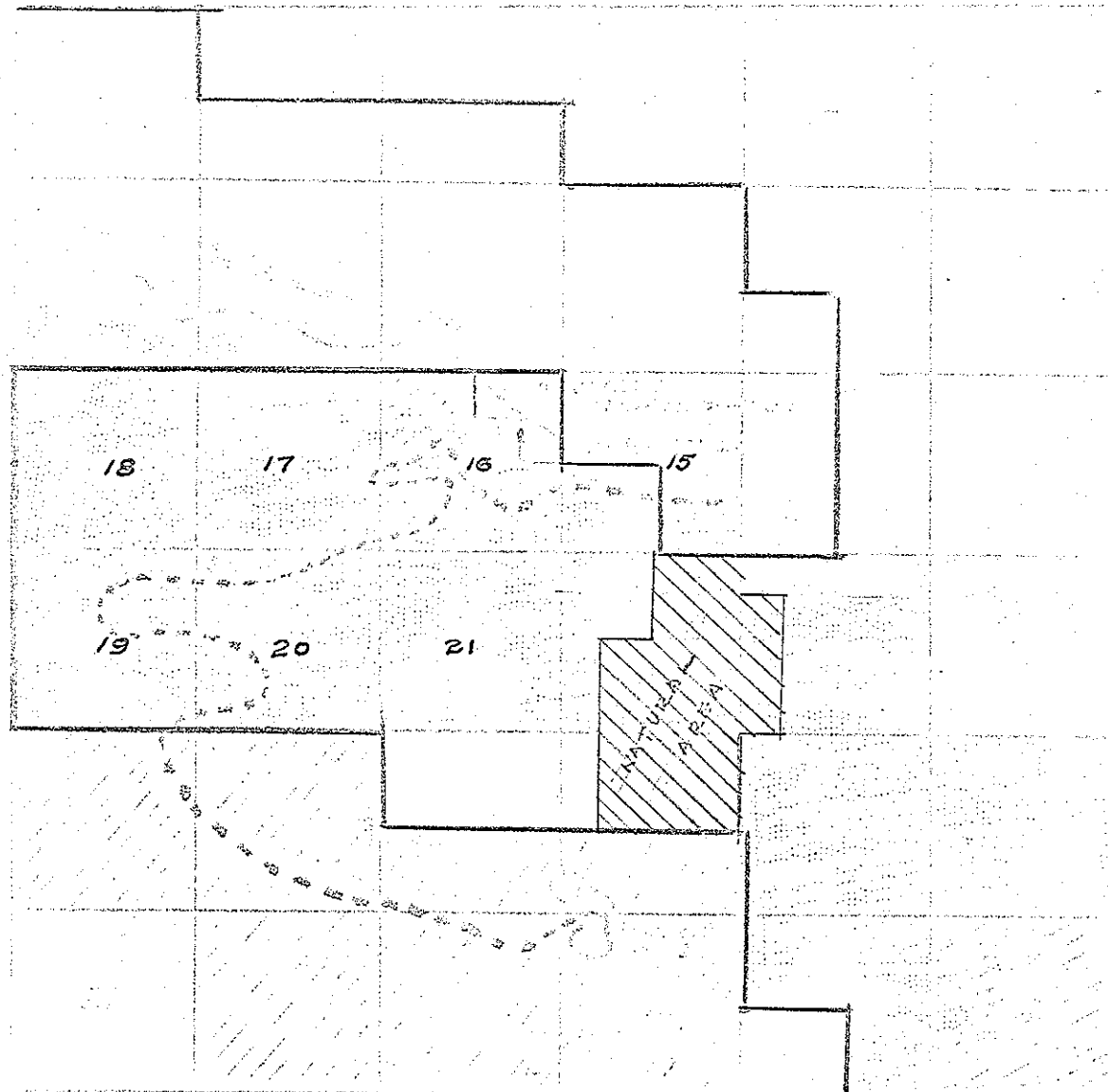

LAKE 22 NATURAL AREA